



LAMB & CO

Call us on 01255 422 240
Inspired by property, driven by passion.



MAIN ROAD, GREAT HOLLAND, CO13 0JN GUIDE PRICE £585,000

**** GUIDE PRICE £585,000 - £600,000 **** Located in the highly sought-after village of Great Holland, this substantial four-bedroom detached home offers spacious and versatile accommodation throughout and is sold with no onward chain. Boasting two reception rooms, including an impressive living area with a feature fireplace with log burner, an en suite to the main bedroom, off-road parking and a double garage.

- Four Bedrooms
- Off-Road Parking & Double Garage
- Two Reception Rooms
- No Onward Chain
- En Suite
- EPC C

Opening paragraph

Accommodation comprises with approximate room sizes as follows:

Entrance door to:

ENTRANCE HALLWAY



KITCHEN/BREAKFAST ROOM

17'3 x 10'0 (5.26m x 3.05m)



PORCH

DINING ROOM

14'0 x 11'0 (4.27m x 3.35m)



OFFICE

11'0 x 7'0 (3.35m x 2.13m)



LOUNGE

19'4 x 15'5 (5.89m x 4.70m)



WC

6'0 x 3'3 (1.83m x 0.99m)



EN SUITE

6'4 x 6'4 (1.93m x 1.93m)



FIRST FLOOR



BEDROOM TWO

16'0 x 14'0 (4.88m x 4.27m)



BEDROOM ONE

13'8 x 12'3 (4.17m x 3.73m)



BEDROOM FOUR

11'8 x 6'1 (3.56m x 1.85m)



BEDROOM THREE

15'7 x 10'9 (4.75m x 3.28m)



BATHROOM

8'1 x 6'9 (2.46m x 2.06m)



OUTSIDE

OUTSIDE REAR



Material Information

Council Tax Band: F

Heating: Gas

Services: All Mains

Broadband: Ultrafast

Mobile Coverage: EE, Three, Vodafone & O2

Construction: Conventional

Restrictions: N/A

Rights & Easements: N/A

Flood Risk: Service Water- Low - Rivers & Sea- Very Low

Additional Charges: N/A

Seller's Position: No Onward Chain

Garden Facing: East/South

Agents Note Sales

PLEASE NOTE - Although we have not tested any of the Gas/Electrical Fixtures & Fittings, we understand them to be in good working order, however it is up to any interested party to satisfy themselves of their condition before entering into any Legal Contract.

AML

ANTI-MONEY LAUNDERING REGULATIONS 2017 - In order to comply with regulations, prospective purchasers will be asked to produce photographic identification and proof of residence documentation once entering into negotiations for a property.

Map



EPC Graphs

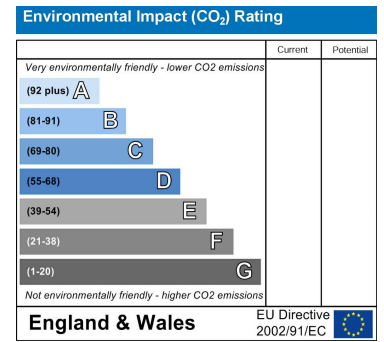
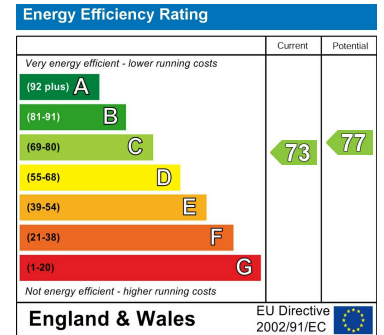

Floorplan

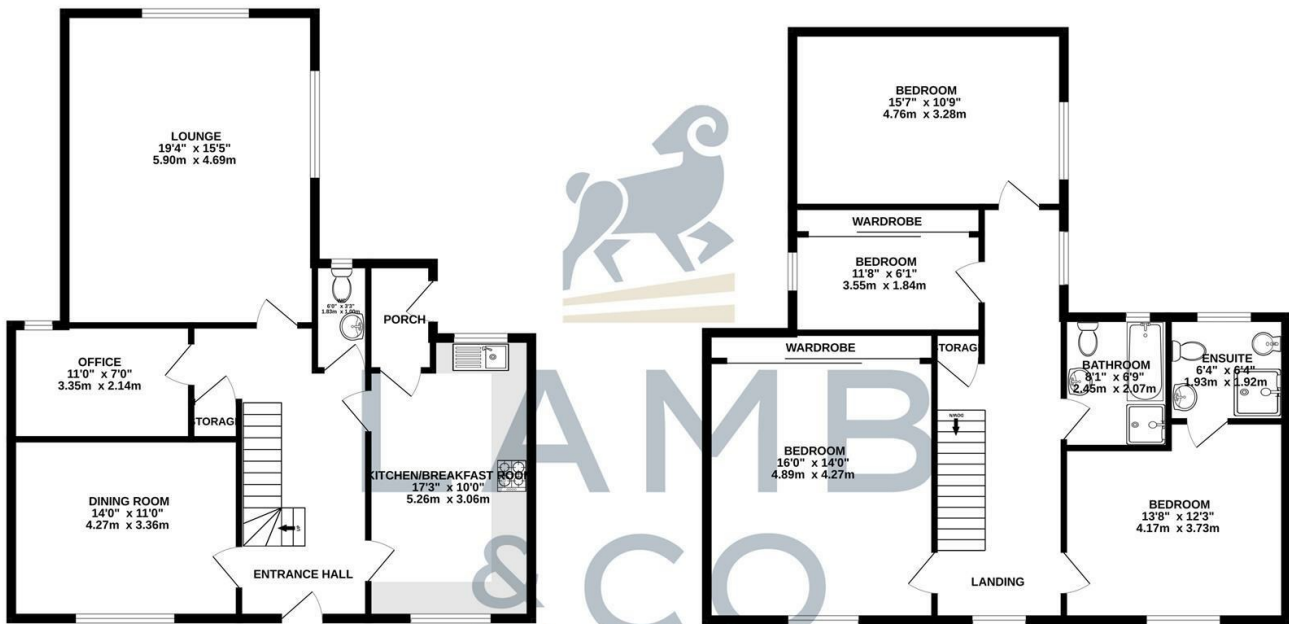

TOTAL FLOOR AREA: 1849 sq.ft. (171.7 sq.m.) approx.

Whilst every attempt has been made to ensure the accuracy of the floorplan contained here, measurements of doors, windows, rooms and any other items are approximate and no responsibility is taken for any error, omission or mis-statement. This plan is for illustrative purposes only and should be used as such by any prospective purchaser. The services, systems and appliances shown have not been tested and no guarantee as to their operability or efficiency can be given.
Made with Metropix ©2026

These particulars, whilst believed to be accurate are set out as a general outline only for guidance and do not constitute any part of an offer or contract. Intending purchasers should not rely on them as statements of representation of fact, but must satisfy themselves by inspection or otherwise as to their accuracy. No person in this firm's employment has the authority to make or give any representation or warranty in respect of the property.